

AdVantage Display®

AdVantage Display® System

The **AdVantage Display®** System is a light-weight and portable system that can be used as a table top or in its full height configuration. Take advantage of this system when you need the following features: Fast and easy set-up • A 360° hinge system for versatility and stability • A variety of case options • Dramatic rear-lit graphics, towers, counters and showcases • Accessories that include header panels, aluminum end caps, literature pockets, slatwall with fixtures and folding light boxes.

AdVantage Fabric Specifications

COLOURS AVAILABLE

<u>FOSS® PREMIERE COLOUR</u>	<u>FOSS® REGAL COLOUR</u>	<u>PMS EQUIV. #</u>
R01 LAVA	R01 CARBON	BLACK 6C 2X
R02 STEEL	R02 CHROME	429U/430U
R03 CHARCOAL	R03 STORM	424C/425C
R04 MONARCH	R04 SAPPHIRE	281C/282C
R05 PACIFIC	R05 ELECTRIC BLUE	280C
R06 INDIGO		249U
R07 SAND		457U
R08 MERLOT		185C
R09 KELLY GREEN		3435C
R11 ELECTRIC RED	R11 CHILI PEPPER	187C
R12 NEBULA		2767C
R15 CINDER		432C

FOSS® PREMIERE FABRIC SPECIFICATIONS

<u>TEST METHOD</u>	<u>PROPERTY</u>	<u>SPECIFICATION</u>
N/A	CONSTRUCTION	Nonwoven Fabric
FTM NW503	WEIGHT	9.5 oz/sq. yd. (322 g/sq. m.)
FTM NW502	WIDTH	As Requested +/- .5" (12.7 mm)
FTM NW504	THICKNESS	.155" (3.9 mm)
FTM NW505	TENSILE STRENGTH	MD 110 lbs. (489N), CMD 150 lbs (667 N)
FTM NW506	ELONGATION (INSTRON @ 25#)	MD 15%, CMD 15%
FTM NW523	PILE HEIGHT	.039" (1.0 mm)
VISUAL	APPEARANCE	MATCHES APPROVED STANDARD
VISUAL	COLOUR	MATCHES APPROVED STANDARD
FTM NW516	ABRASION	NO WORSE THAN APPROVED STANDARD

FOSS® REGAL FABRIC SPECIFICATIONS

<u>TEST METHOD</u>	<u>PROPERTY</u>	<u>SPECIFICATION</u>
N/A	CONSTRUCTION	Nonwoven Fabric
FTM NW503	WEIGHT	9.0 oz/sq. yd. (305 g/sq. m.)
FTM NW502	WIDTH	As Requested +/- .5" (12.7 mm)
FTM NW504	THICKNESS	.125" (3.2 mm)

AdVantage Fabric Specifications Cont'd.

FOSS® REGAL FABRIC SPECIFICATIONS CONT'D.

<u>TEST METHOD</u>	<u>PROPERTY</u>	<u>SPECIFICATION</u>
FTM NW505	TENSILE STRENGTH	MD 140 lbs. (623N), CMD 170 lbs (756 N)
FTM NW506	ELONGATION (INSTRON @ 25#)	MD 18%, CMD 17%
FTM NW523	PILE HEIGHT	.039" (1.0 mm)
VISUAL	APPEARANCE	MATCHES APPROVED STANDARD
VISUAL	COLOUR	MATCHES APPROVED STANDARD
FTM NW516	ABRASION	NO WORSE THAN APPROVED STANDARD

AdVantage Panel

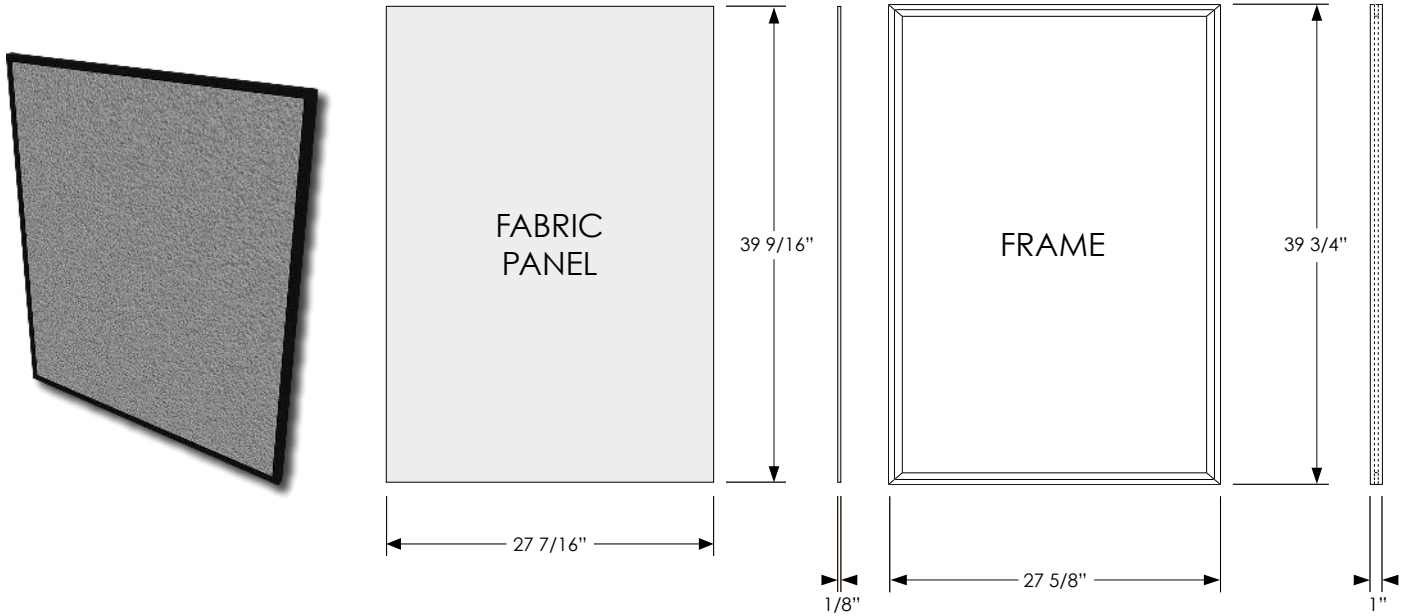

CODE	DESCRIPTION
A-FP	Fabric Panel
A-1S	Silver Frame
A-1B	Black Frame

SIZE	WEIGHT (lbs)
27 7/16"W x 39 9/16"H x 1/8"T	1.0
27 5/8"W x 39 3/4"H x 1"T	2.5
27 5/8"W x 39 3/4"H x 1"T	2.5

AdVantage 1/2 Panel

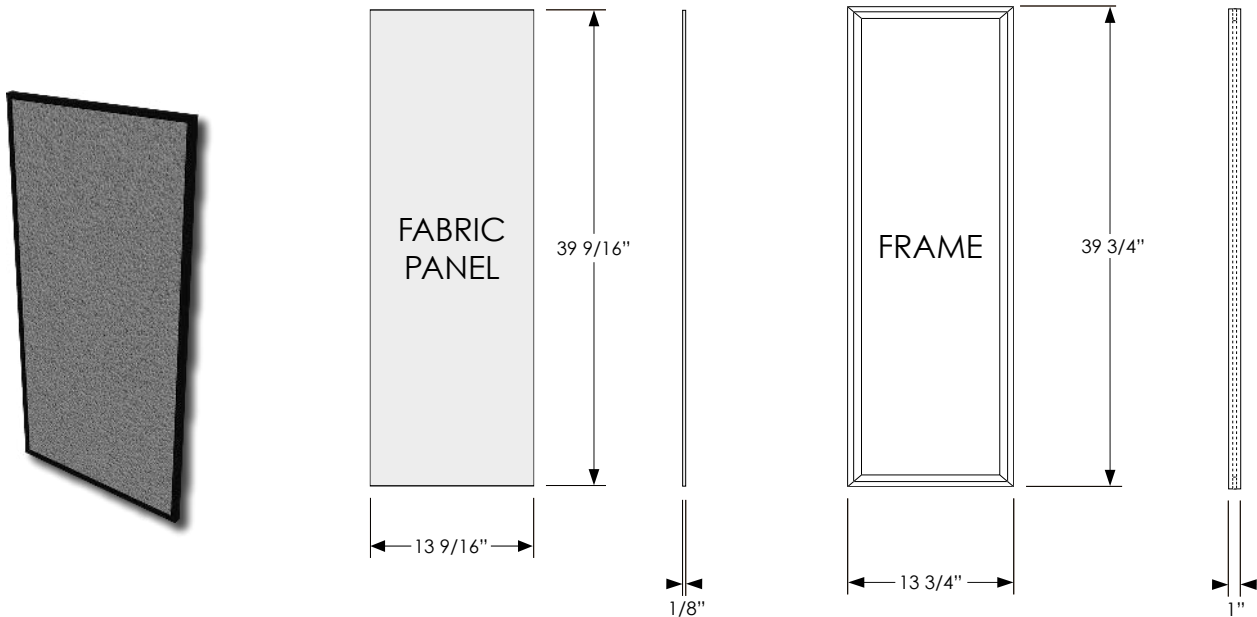

CODE	DESCRIPTION
A-1/2FP	1/2 Size Fabric Panel
A-1/2S	1/2 Size Silver Frame
A-1/2B	1/2 Size Black Frame

SIZE	WEIGHT (lbs)
13 9/16"W x 39 9/16"H x 1/8"T	.6
13 3/4"W x 39 3/4"H x 1"T	1.5
13 3/4"W x 39 3/4"H x 1"T	1.5

AdVantage Slatwall Panel

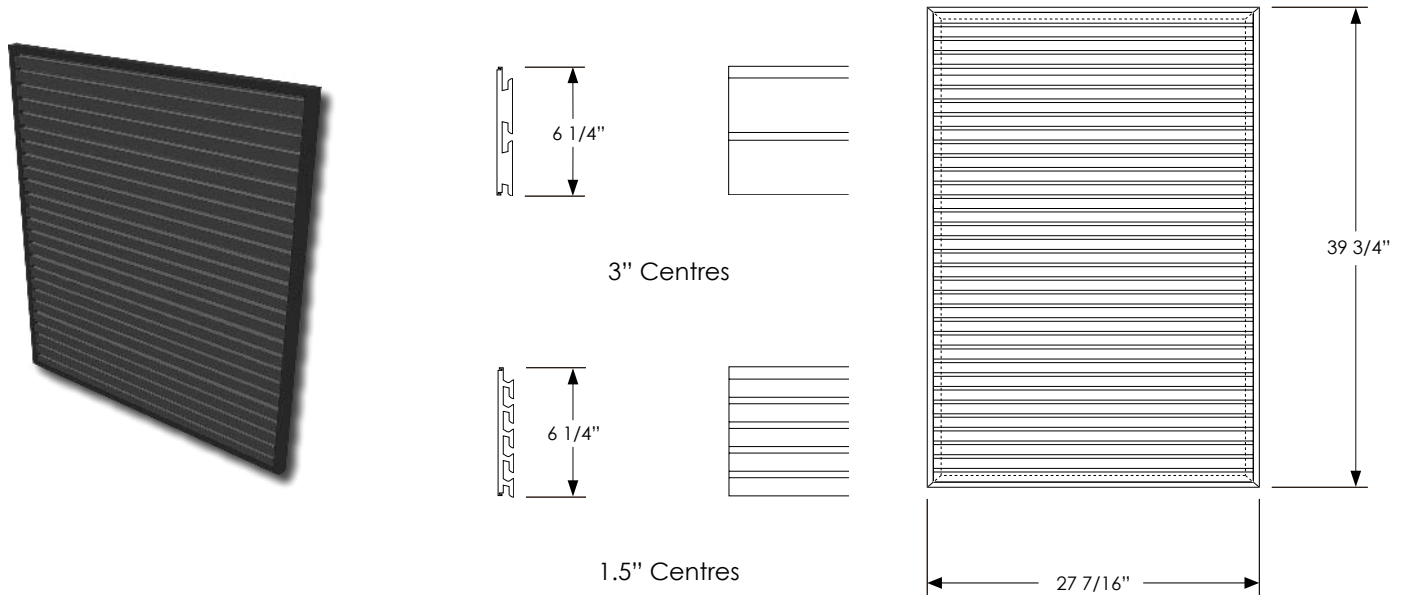

CODE	DESCRIPTION	SIZE	WEIGHT (lbs)
A-SSWP	Slatwall Panel Set w/1.5" Centres	27 7/16"W x 39 9/16"H x 3/4"T	12.0
A-SSWR	Slatwall Panel Set w/3" Centres	27 7/16"W x 39 9/16"H x 3/4"T	10.25
A-1S	Silver Frame	27 5/8"W x 39 3/4"H x 1"T	2.5
A-1B	Black Frame	27 5/8"W x 39 3/4"H x 1"T	2.5

AdVantage Header Panel

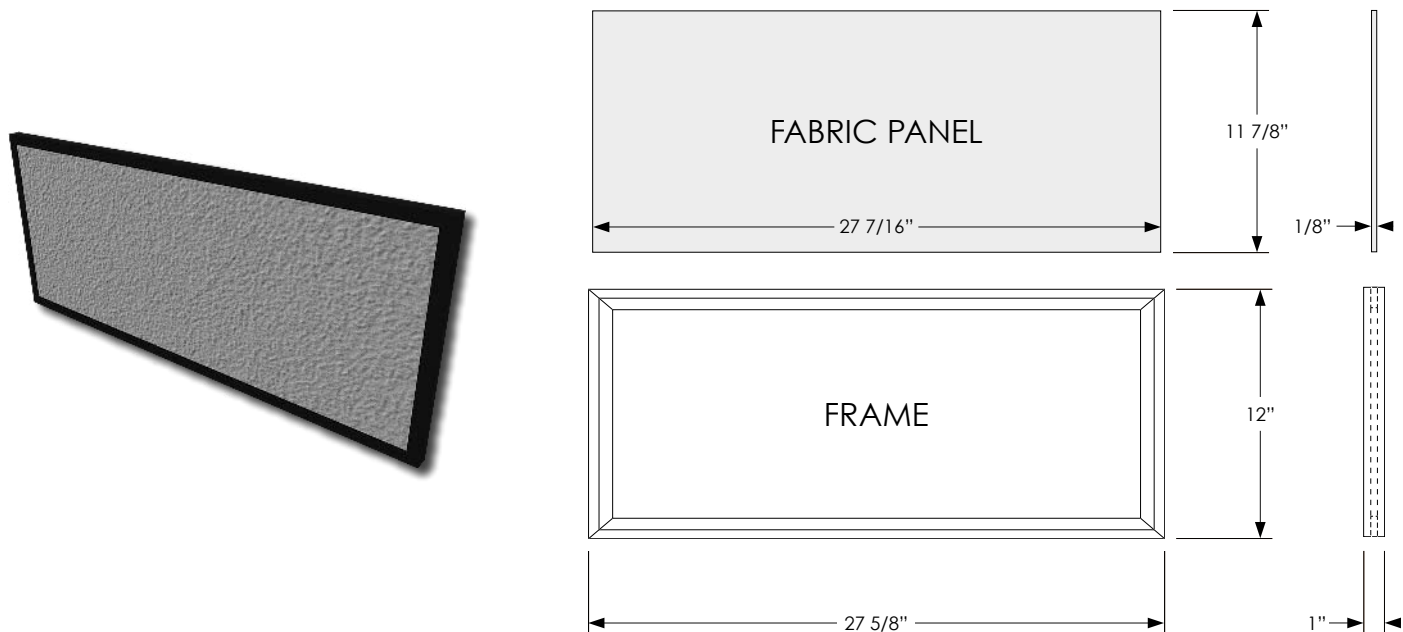

CODE	DESCRIPTION	SIZE	WEIGHT (lbs)
A-FHP	Fabric Header Panel	27 7/16"W x 11 7/8"H x 1/8"T	.6
A-HS	Silver Header Frame	27 5/8"W x 12"H x 1"T	1.5
A-HB	Black Header Frame	27 5/8"W x 12"H x 1"T	1.5

AdVantage End Caps

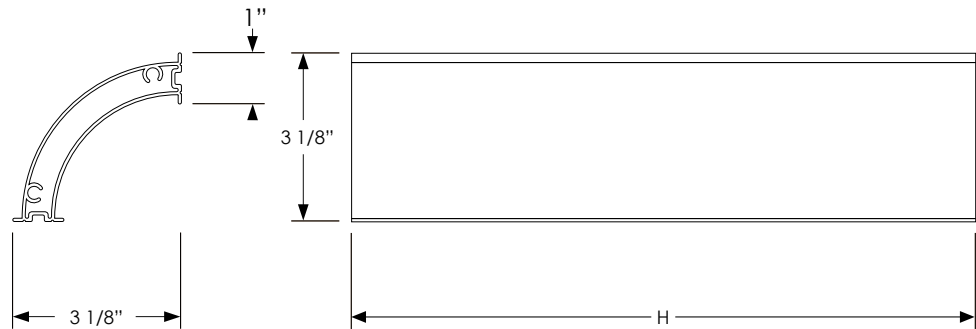

CODE	DESCRIPTION
A-CB	4-Piece Black Aluminum End Cap Set
A-HCB	2-Piece Black Aluminum Header End Cap Set

SIZE (ea.)
39 3/4"H x 3 1/8"W x 3 1/8"D
12"H x 3 1/8"W x 3 1/8"D

WEIGHT (lbs)
12.0
1.8

AdVantage Table Top w/Single Header

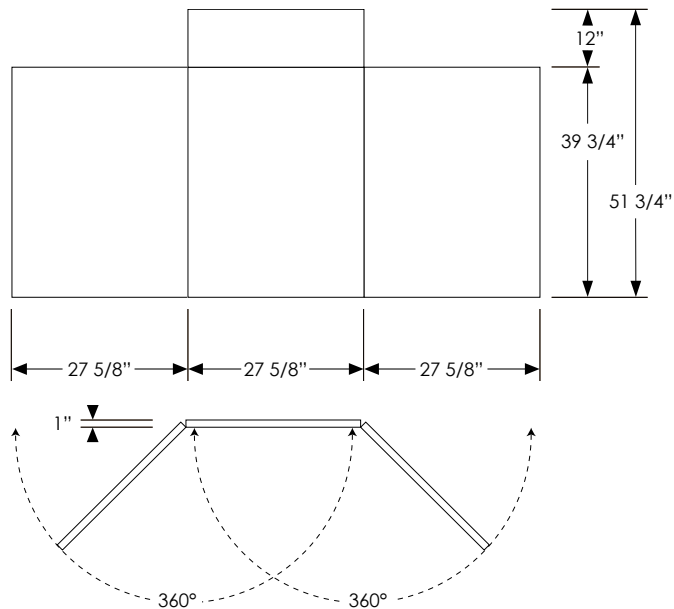
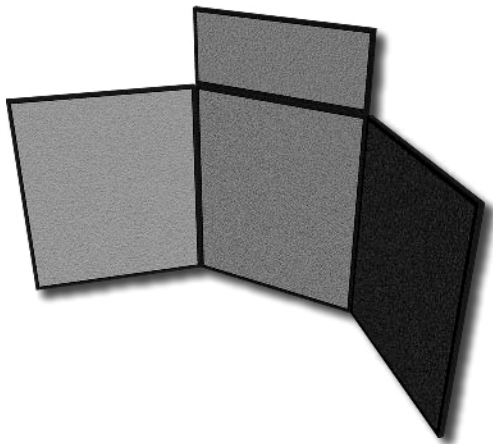

QTY.	CODE	DESCRIPTION
1	A-3TS/A-3TB	3-Piece Folding Silver/Black Frame Unit
1	A-HS/A-HB	Silver/Black Header Frame
3	A-FP	Fabric Panels
1	A-FHP	Fabric Header Panel

SIZE
82 7/8"W x 39 3/4"H x 1"T
27 5/8"W x 12"H x 1"T
27 7/16"W x 39 9/16"H x 1/8"T
13 7/16"W x 39 9/16"H x 1/8"T

WEIGHT (lbs)
7.5
1.5
3.0
.6

AdVantage 6-Frame w/Single Header

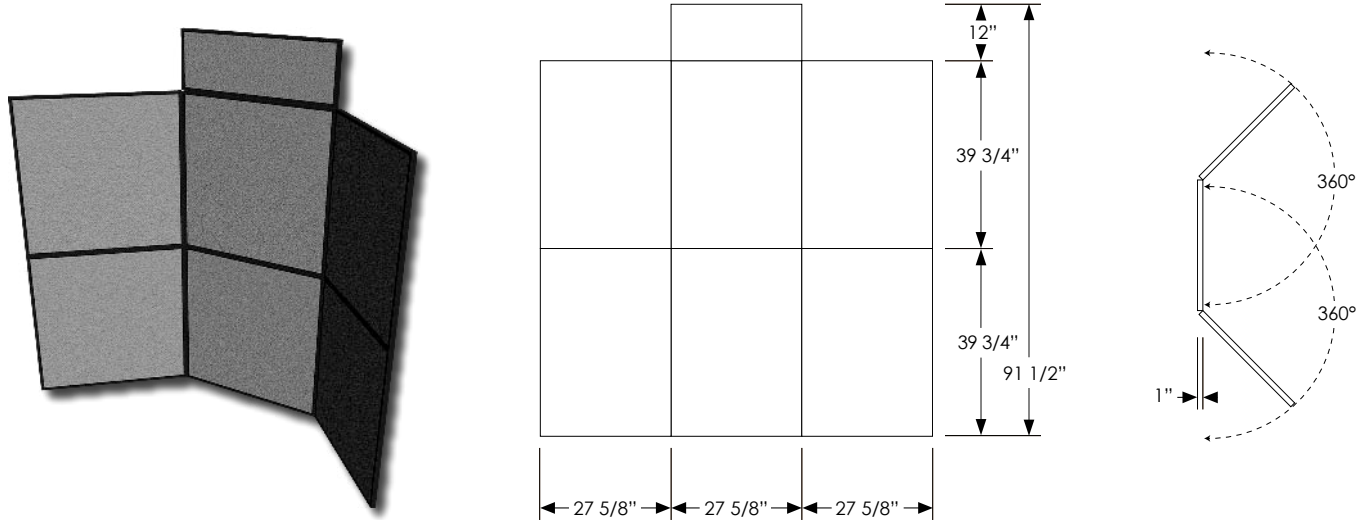

QTY.	CODE	DESCRIPTION	SIZE	WEIGHT (lbs)
1	A-6S/A-6B	6-Piece Folding Silver/Black Frame Unit	82 7/8"W x 79 1/2"H x 1"T	15.0
1	A-HS/A-HB	Silver/Black Header Frame	27 5/8"W x 12"H x 1"T	1.5
6	A-FP	Fabric Panels	27 7/16"W x 39 9/16"H x 1/8"T	6.0
1	A-FHP	Fabric Header Panel	27 7/16"W x 11 7/8"H x 1/8"T	.6

AdVantage 6-Frame w/3 Headers

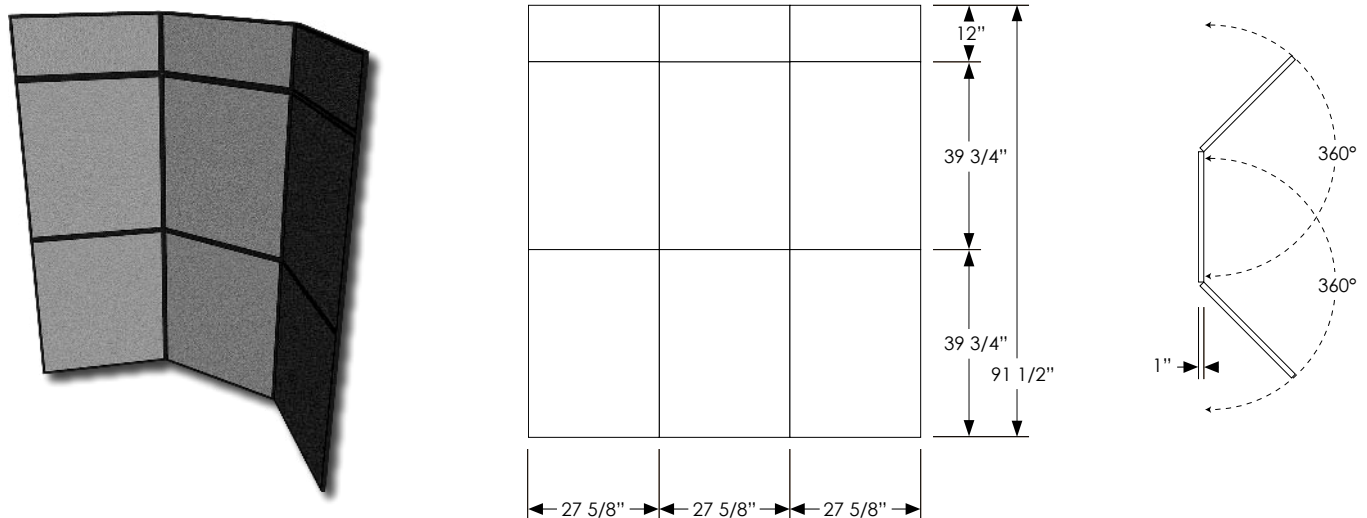

QTY.	CODE	DESCRIPTION	SIZE	WEIGHT (lbs)
1	A-6S/A-6B	6-Piece Folding Silver/Black Frame Unit	82 7/8"W x 79 1/2"H x 1"T	15.0
1	A-3HS/A-3HB	3-Piece Folding Silver/Black Header Frame Unit	82 7/8"W x 12"H x 1"T	4.5
6	A-FP	Fabric Panels	27 7/16"W x 39 9/16"H x 1/8"T	6.0
3	A-FHP	Fabric Header Panels	27 7/16"W x 11 7/8"H x 1/8"T	1.8

AdVantage 6-Frame w/3 Headers & End Caps

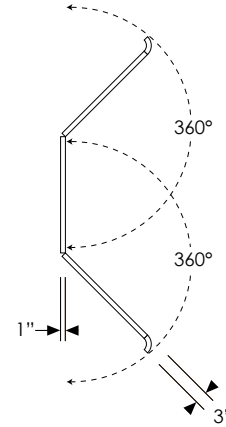
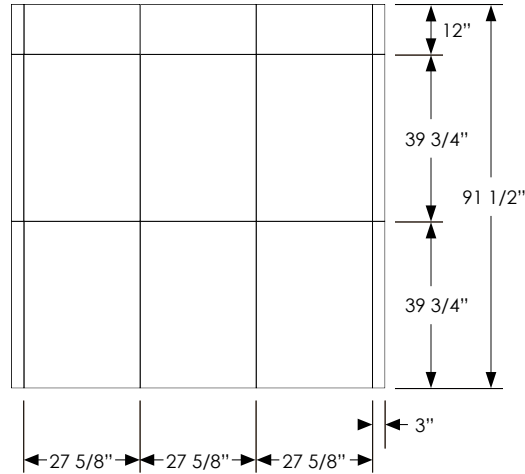
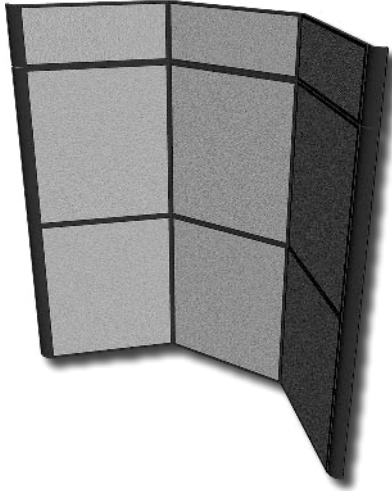

QTY.	CODE	DESCRIPTION	SIZE	WEIGHT (lbs)
1	A-6S/A-6B	6-Piece Folding Silver/Black Frame Unit	82 7/8"W x 79 1/2"H x 1"T	15.0
1	A-3HS/A-3HB	3-Piece Folding Silver/Black Header Frame Unit	82 7/8"W x 12"H x 1"T	4.5
6	A-FP	Fabric Panels	27 7/16"W x 39 9/16"H x 1/8"T	6.0
3	A-FHP	Fabric Header Panels	27 7/16"W x 11 7/8"H x 1/8"T	1.8
1	A-CB	4-Piece Black End Cap Set	79 1/2"H x 3 1/8"W x 3 1/8"D	12.0
1	A-HCB	2-Piece Black Header End Cap Set	12"H x 3 1/8"W x 3 1/8"D	1.8

AdVantage 8-Frame w/2 Headers

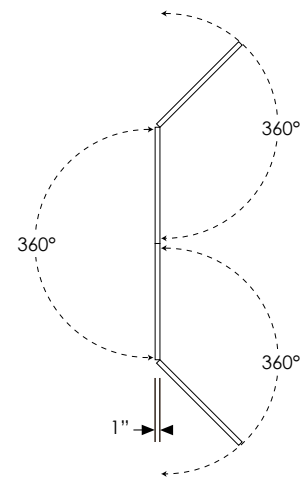
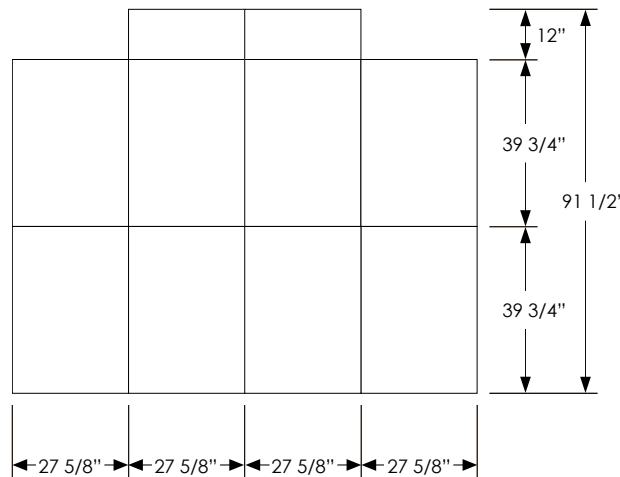
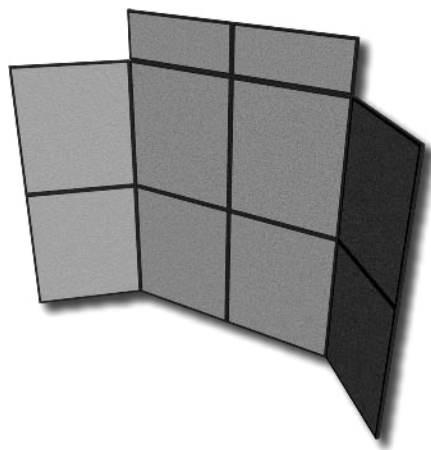

QTY.	CODE	DESCRIPTION	SIZE	WEIGHT (lbs)
1	A-8S/A-8B	8-Piece Folding Silver/Black Frame Unit	110 1/2"W x 79 1/2"H x 1"T	20.0
1	A-2HS/A-2HB	2-Piece Folding Silver/Black Header Frame Unit	55 1/4"W x 12"H x 1"T	3.0
8	A-FP	Fabric Panels	27 7/16"W x 39 9/16"H x 1/8"T	8.0
2	A-FHP	Fabric Header Panels	27 7/16"W x 11 7/8"H x 1/8"T	1.2

AdVantage 8-Frame w/4 Headers

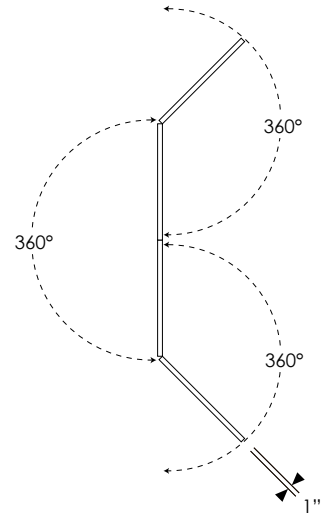
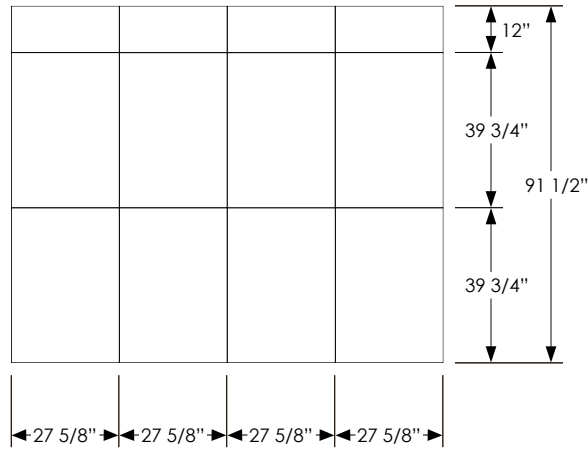
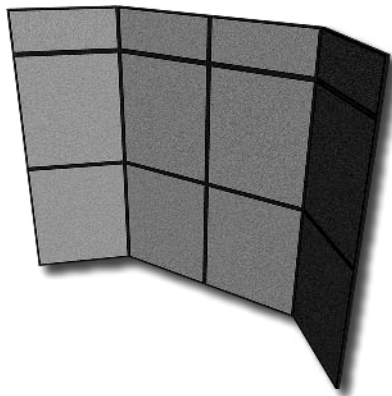

QTY.	CODE	DESCRIPTION	SIZE	WEIGHT (lbs)
1	A-8S/A-8B	8-Piece Folding Silver/Black Frame Unit	110 1/2"W x 79 1/2"H x 1"T	20.0
2	A-2HS/A-2HB	2-Piece Folding Silver/Black Header Frame Units	110 1/2"W x 12"H x 1"T	6.0
8	A-FP	Fabric Panels	27 7/16"W x 39 9/16"H x 1/8"T	8.0
4	A-FHP	Fabric Header Panels	27 7/16"W x 11 7/8"H x 1/8"T	2.4

AdVantage 8-Frame w/4 Headers & End Caps

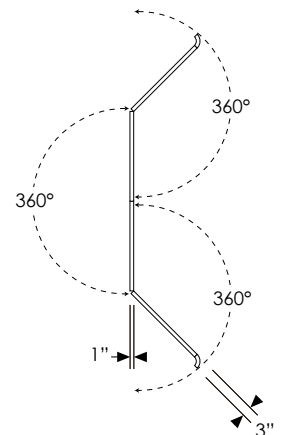
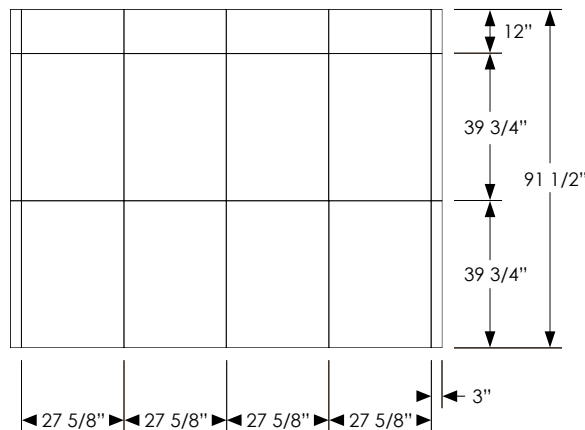
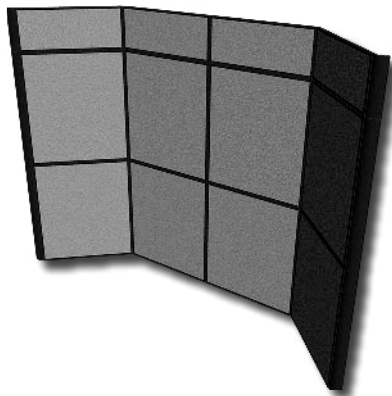

QTY.	CODE	DESCRIPTION	SIZE	WEIGHT (lbs)
1	A-8S/A-8B	8-Piece Folding Silver/Black Frame Unit	110 1/2"W x 79 1/2"H x 1"T	20.0
2	A-2HS/A-2HB	2-Piece Folding Silver/Black Header Frame Units	110 1/2"W x 12"H x 1"T	6.0
8	A-FP	Fabric Panels	27 7/16"W x 39 9/16"H x 1/8"T	8.0
4	A-FHP	Fabric Header Panels	27 7/16"W x 11 7/8"H x 1/8"T	2.4
1	A-CB	4-Piece Black End Cap Set	79 1/2"H x 3 1/8"W x 3 1/8"D	12.0
1	A-HCB	2-Piece Black Header End Cap Set	12"H x 3 1/8"W x 3 1/8"D	1.8

AdVantage 8-Frame w/Slatwall Panels

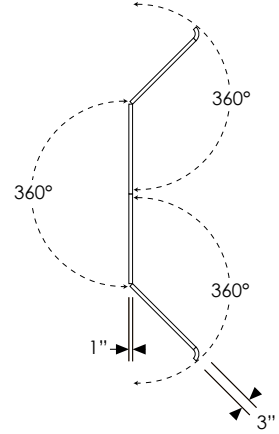
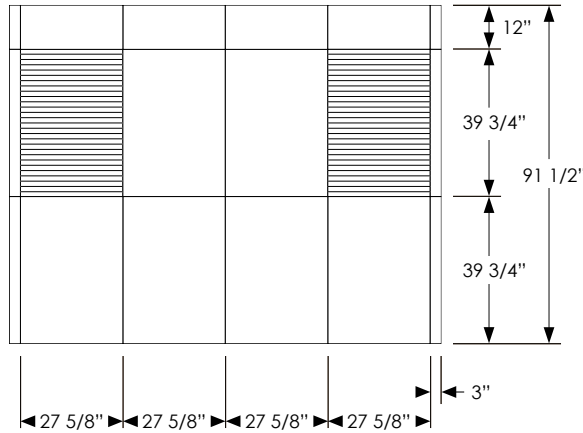
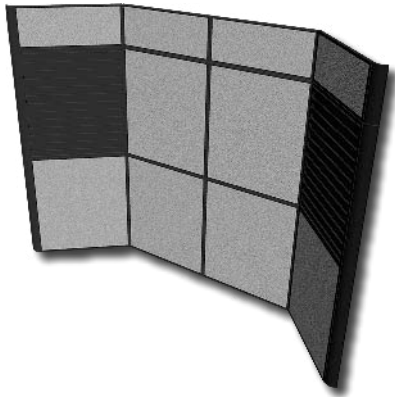

QTY.	CODE	DESCRIPTION	SIZE	WEIGHT (lbs)
1	A-8S/A-8B	8-Piece Folding Silver/Black Frame Unit	110 1/2"W x 79 1/2"H x 1"T	20.0
2	A-2HS/A-2HB	2-Piece Folding Silver/Black Header Frame Units	110 1/2"W x 12"H x 1"T	6.0
6	A-FP	Fabric Panels	27 7/16"W x 39 9/16"H x 1/8"T	6.0
2	A-SSWP/A-SSWR	Slatwall 1.5"/3" Centre Panels	27 7/16"W x 39 9/16"H x 3/4"T	24.0/20.5
4	A-FHP	Fabric Header Panels	27 7/16"W x 11 7/8"H x 1/8"T	2.4
1	A-CB	4-Piece Black End Cap Set	79 1/2"H x 3 1/8"W x 3 1/8"D	12.0
1	A-HCB	2-Piece Black Header End Cap Set	12"H x 3 1/8"W x 3 1/8"D	1.8

AdVantage 10' w/Counter

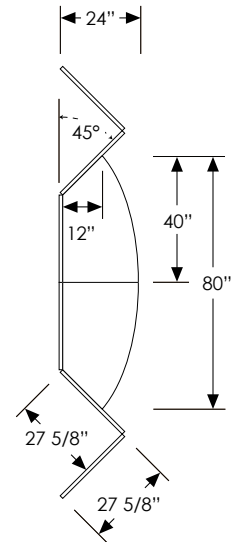
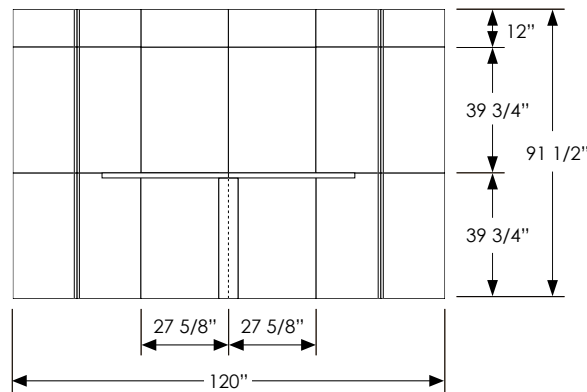
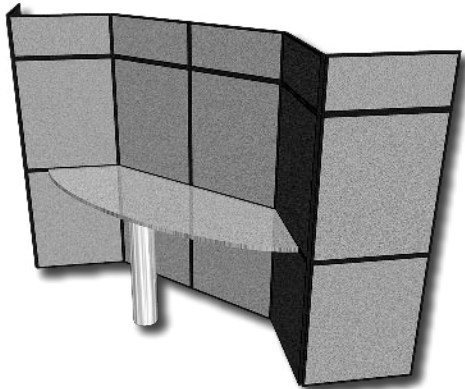

QTY.	CODE	DESCRIPTION	SIZE	WEIGHT (lbs)
2	A-6S/A-6B	6-Piece Folding Silver/Black Frame Units	82 7/8"W x 79 1/2"H x 1"T	30.0
2	A-3HS/A-3HB	3-Piece Folding Silver/Black Header Frame Units	82 7/8"W x 12"H x 1"T	9.0
12	A-FP	Fabric Panels	27 7/16"W x 39 9/16"H x 1/8"T	12.0
6	A-FHP	Fabric Header Panels	27 7/16"W x 11 7/8"H x 1/8"T	3.6
1	A-CT80X24	2-Piece Countertop	80"W x 1"H x 24"D	30.0
1	A-CB	4-Piece End Cap Set (Countertop Support)	6 1/4"W x 39 3/4"H x 6 1/4"D	12.0

AdVantage 20' w/Counters

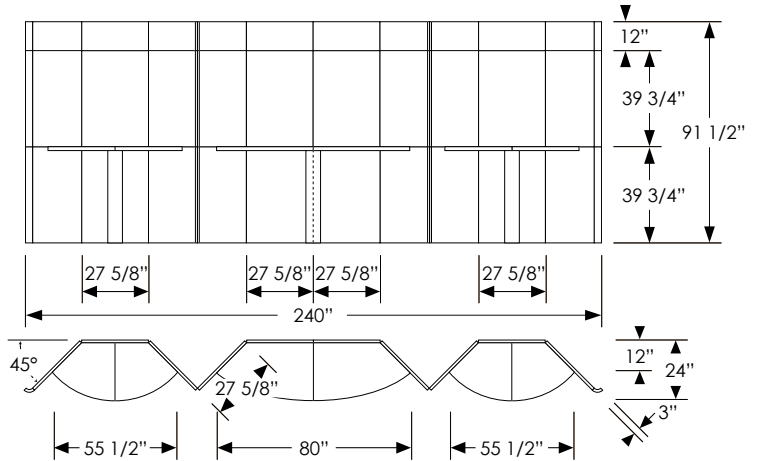
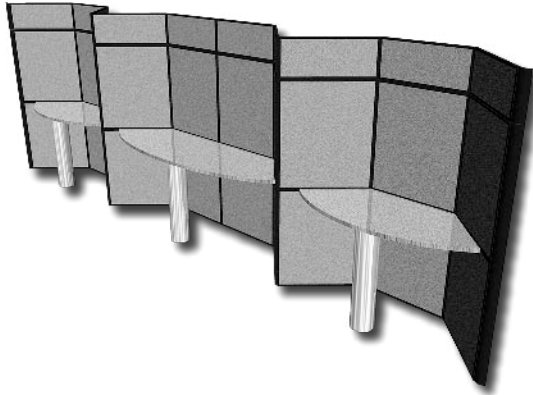

QTY.	CODE	DESCRIPTION	SIZE	WEIGHT (lbs)
1	A-8S/A-8B	8-Piece Folding Silver/Black Frame Unit	110 1/2"W x 79 1/2"H x 1"T	20.0
2	A-6S/A-6B	6-Piece Folding Silver/Black Frame Units	82 7/8"W x 79 1/2"H x 1"T	30.0
2	A-3HS/A-3HB	3-Piece Folding Silver/Black Header Frame Units	82 7/8"W x 12"H x 1"T	9.0
2	A-2HS/A-2HB	2-Piece Folding Silver/Black Header Frame Units	60 1/4"W x 12"H x 1"T	6.0
20	A-FP	Fabric Panels	27 7/16"W x 39 9/16"H x 1/8"T	20.0
10	A-FHP	Fabric Header Panels	27 7/16"W x 11 7/8"H x 1/8"T	6.0
1	A-CB	4-Piece Black End Cap Set	79 1/2"H x 3 1/8"W x 3 1/8"D	12.0
1	A-HCB	2-Piece Black Header End Cap Set	12"H x 3 1/8"W x 3 1/8"D	1.8
1	A-CT80X24	2-Piece Countertop	80"W x 1"H x 24"D	30.0
2	A-CT155x24	1-Piece Countertops	55 1/2"W x 1"H x 24"D	42.0
3	A-CB	4-Piece End Cap Sets (Countertop Supports)	6 1/4"W x 39 3/4"H x 6 1/4"D	36.0

AdVantage Counter

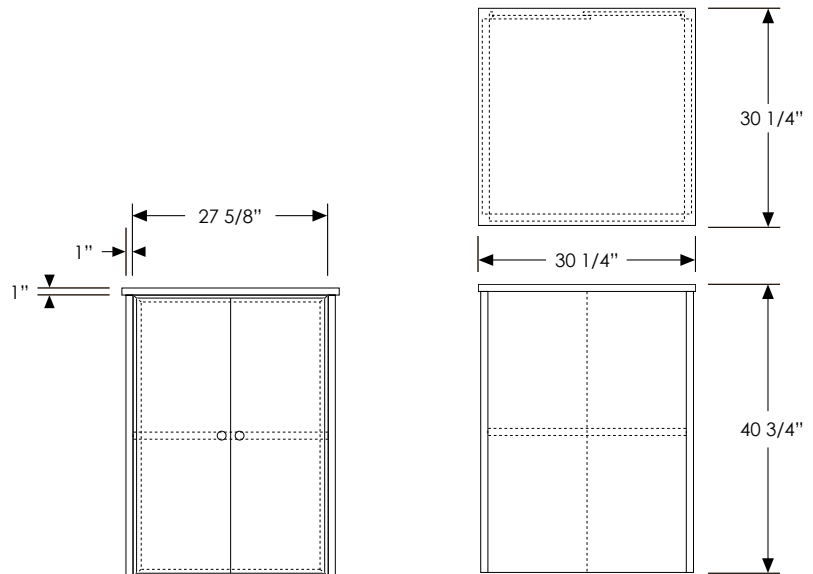
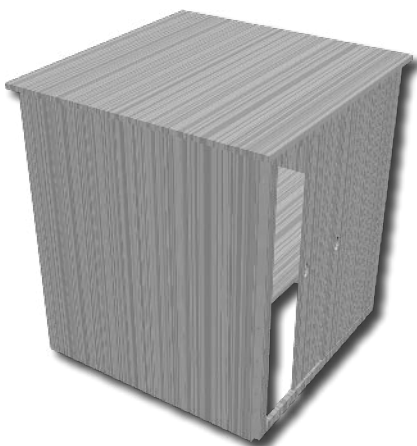

QTY.	CODE	DESCRIPTION	SIZE	WEIGHT (lbs)
1	A-4TS/A-4TB	4-Piece Silver/Black Frame Unit	30 1/4"W x 40 3/4"H x 30 1/4"D	10.0
3	A-FP	Fabric Panels	27 7/16"W x 39 9/16"H x 1/8"D	3.0
1	A-SDF	2-Piece Sliding Door Panel Set	15 3/4"W x 39 3/4"H x 1/8"T	9.7
1	A-CSQ	Square P-LAM Counter Top	30 1/4"W x 1"H x 30 1/4"D	20.0
1	A-CISQ	Square Inside Clip Shelf	27 5/8"W x 1"H x 27 5/8"D	16.0
2	A-ISP	Internal Shelf Panels	27 7/16"W x 39 9/16"H x 1/8"D	16.0

AdVantage Half-Depth Counter w/Open Back

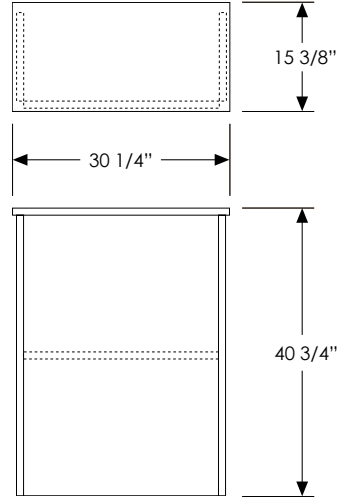
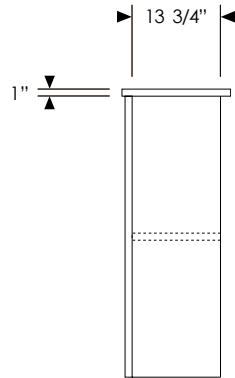
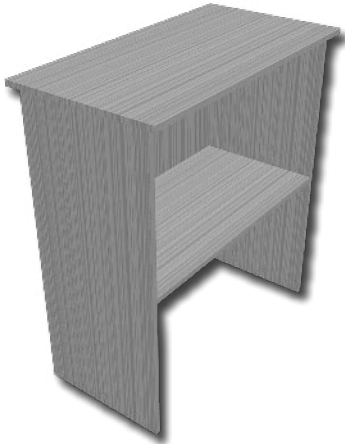

QTY.	CODE	DESCRIPTION
1	A-3TS/A-3TB	3-Piece Silver/Black Frame Unit
1	A-FP	Fabric Panel
2	A-1/2FP	Fabric Half Panels
1	A-CT	Rectangular P-LAM Counter Top
1	A-1/2CISQ	Rectangular Inside Clip Shelf
2	A-1/2ISP	Internal Shelf Panels

SIZE	WEIGHT (lbs)
30 1/4"W x 39 3/4"H x 13 3/4"D	5.5
27 7/16"W x 39 9/16"H x 1/8"T	1.0
13 9/16"W x 39 9/16"H x 1/8"D	1.2
30 1/4"W x 1"H x 15 3/8"D	6.0
27 5/8"W x 5/8"H x 13 3/8"D	5.7
13 9/16"W x 39 3/8"H x 1/8"D	5.7

AdVantage Curved Counter

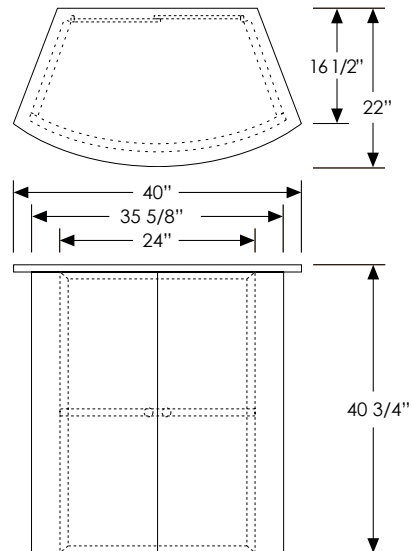
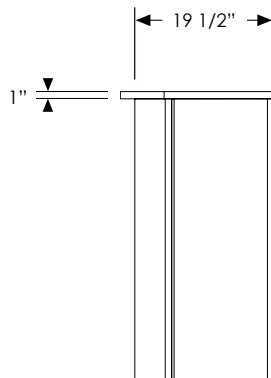
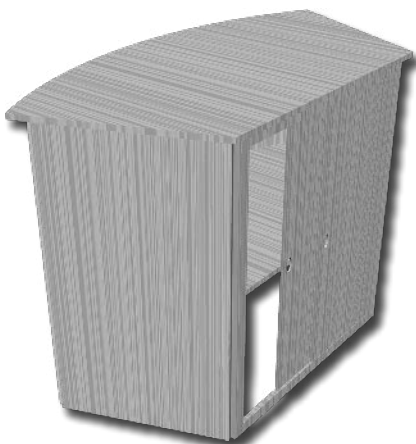

QTY.	CODE	DESCRIPTION
1	A-3CTS/A-3CTB	3-Frame Silver/Black Counter Unit
1	A-CTC	Curved Counter Top
1	A-SDF	2-Piece Sliding Door Panel Set
2	A-1/2FP	Fabric Half Panels
1	A-TAMBOUR-3CT	Tambour Skirt for A-3CT Frame
1	A-1/2CTC	Internal Shelf
1	A-1/2ISP	Internal Shelf Panel

SIZE	WEIGHT (lbs)
35 5/8"W x 39 3/4"H x 13 3/4"D	13.0
40"W x 1"H x 22"D	21.0
15 3/4"W x 39 3/4"H x 1/8"T	9.7
13 9/16"W x 39 9/16"H x 1/8"D	4.2
36"W x 39 9/16"H x 1/4"D	5.0
33 5/8"W x 1"H x 17 1/2"D	4.5
13 9/16"W x 39 9/16"H x 1/8"D	4.5

AdVantage 75 Watt Lights

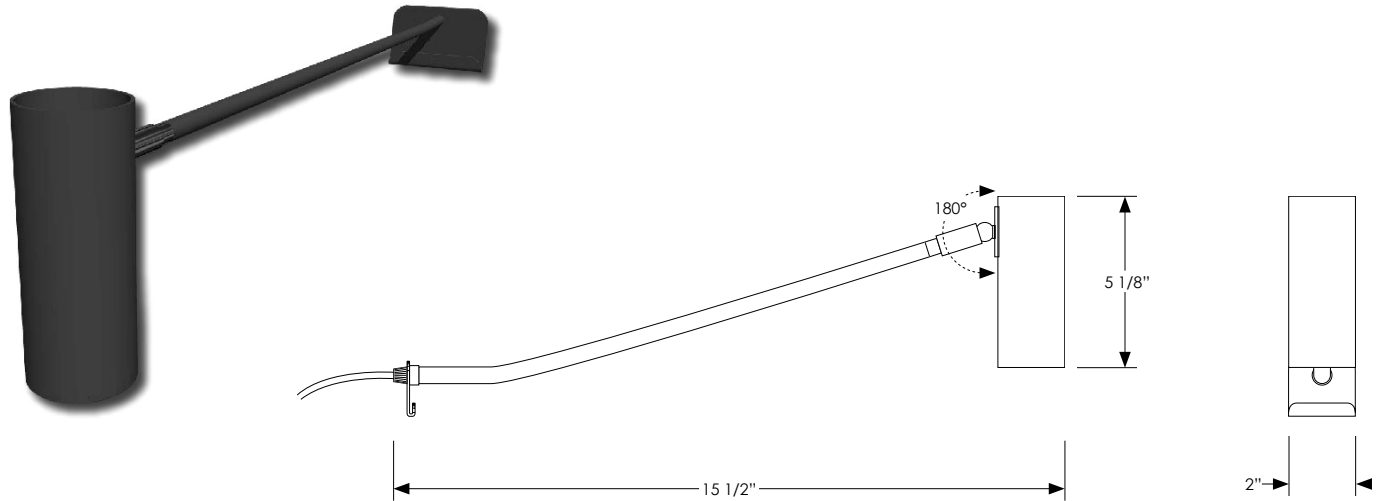

CODE
A-ILS
A-ILB

DESCRIPTION
Silver Fixture Arm Light w/75W Sealed Halogen Bulb
Black Fixture Arm Light w/75W Sealed Halogen Bulb

SIZE
15 1/2"L x 2"W x 5 3/8"H
15 1/2"L x 2"W x 5 3/8"H

WEIGHT (lbs)
1.3
1.3

AdVantage 200 Watt Floodlights

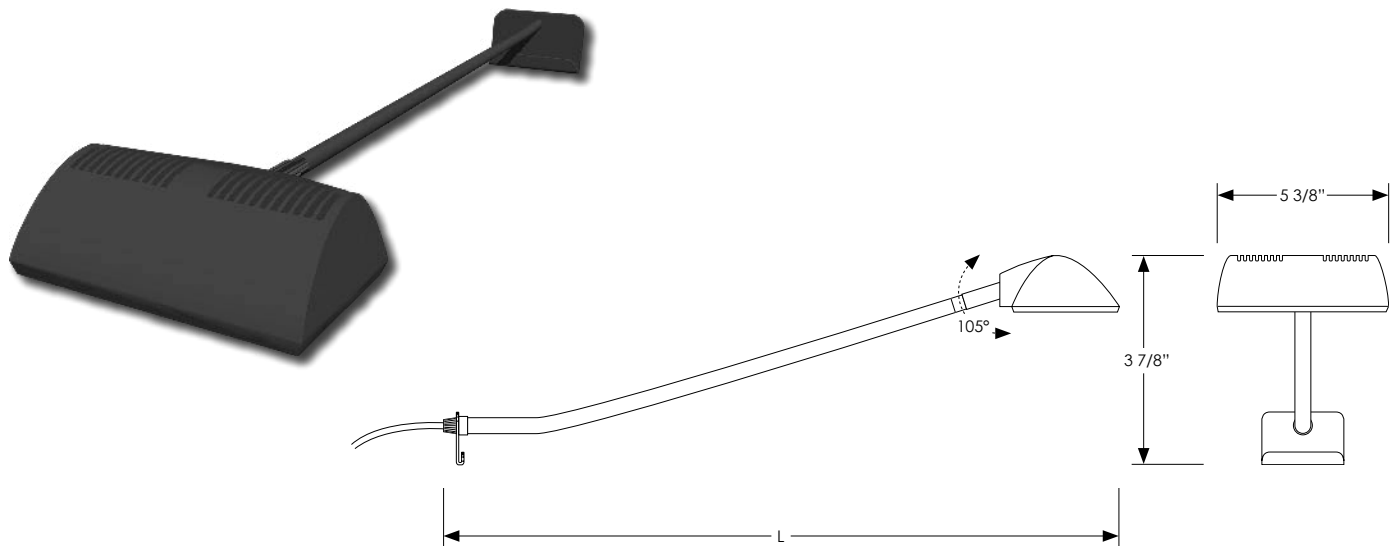

CODE
A-HGS
A-HS1

DESCRIPTION
Black 200W Halogen Shortarm Floodlight
Black 200W Halogen Floodlight

SIZE
13 1/4"L x 5 3/8"W x 3 7/8"H
17"L x 5 3/8"W x 1 3/4"H

WEIGHT (lbs)
1.7
1.8

AdVantage Moulded Plastic Case

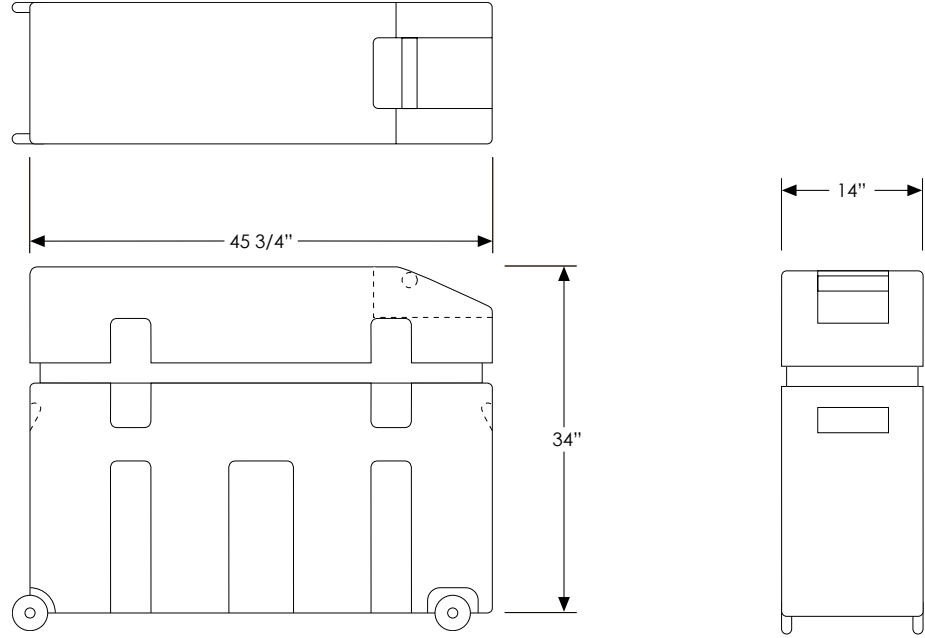

CODE	DESCRIPTION	SIZE	WEIGHT (lbs)
A-RCC	Moulded Plastic Transport Case	45 3/4"L x 34"H x 14"D	44.0

AdVantage Carry Bags

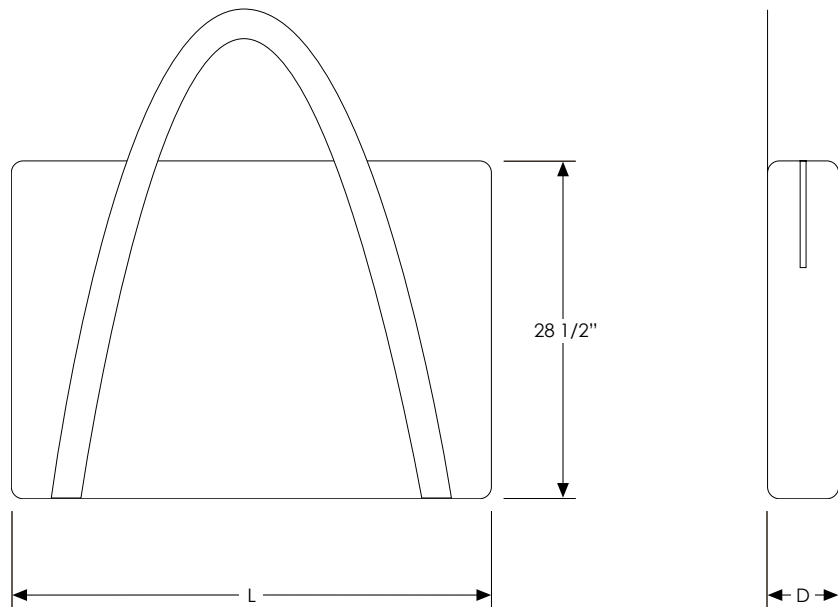

CODE	DESCRIPTION	SIZE	WEIGHT (lbs)
A-CB5	5-Frame Carry Bag	42"L x 28 1/2"H x 6"D	3.0
A-CB10	10-Frame Carry Bag	42"L x 28 1/2"H x 11"D	3.3