

A-LINE

A Versatile Modular Aluminum System.

The basic idea of the A-Line System is logical simplicity. This modular aluminum system consists of parts which are easily connected with an Allen Key as the only tool, making it just as easy to take-apart or rebuild as it is to assemble. This makes it possible to ship your display completely knocked down, making transportation economical.

A wide range of aluminum components and accessories gives you a maximum of possibilities. You can create your own display or choose from our wide-range of designs.

Combinable and modular with endless options and uses, the A-Line System provides a flexible solution to satisfy all of your display requirements. Get creative!

Please contact us for more information.



We have all the parts & the ideas ...

You can choose to have all the parts assembled or knocked down for easy transport.

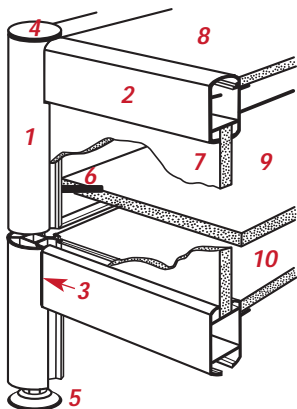

BASIC COMPONENTS:

1. Vertical extrusion
2. Horizontal extrusion
3. Coupling
4. Endcap
5. Adjustable foot
6. Shelf support
7. Panel
8. Top Shelf
9. Adjustable Shelf
10. Bottom shelf

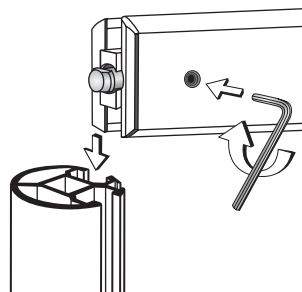

ASSEMBLY:

To connect horizontal to vertical, slide the coupling into the main track of the vertical and tighten firmly with an Allen Key.



A FEW FEATURES & ACCESSORIES:



Panels slide into vertical & horizontal tracks (5/16" / 8 mm) that also cover the edges.

For thicker panel (max. 3/4" / 19 mm), add channel #1190.



Insert tracks for sliding door



For stepless adjustable shelves, use shelf support #1240



To extend or split verticals, use spigot #1242